

BLADE PROTECTORS

BP Series Blade Protectors

The BP series offers the greatest flexibility of curved and straight-end geometries, hardfacing, and AR wearpatch options. BP Series plow guards provide superior wear protection by using over 6 pounds of carbide hardfacing on the bottom wear edge, and the curved version features a rectangular carbide hardfacing patch on the curved surface for wear protection against curbs and jersey barriers. This series also comes in various gauges and bolt patterns to work with multiple types of plows.



Blade Protector Curve, Right or Left
Part #: BP126xxxCR/L

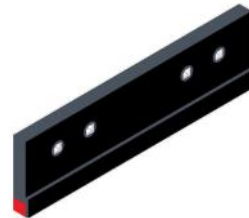

Blade Protector Curve, Straight
Part #: BP126xxxS



Blade Protector, Straight Mini
Part #: BP126xxxSM



Blade Protector, Curb Runner
Part #: BP126xxxSER/L

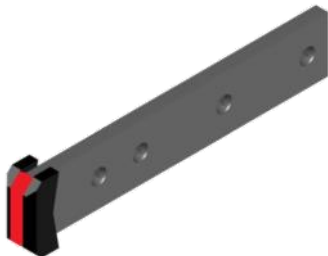

Blade Protector, Universal
Part #: UG-478

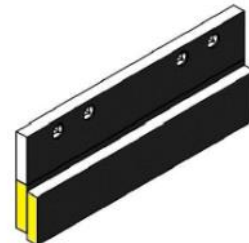

Blade Protector, AR
Part #: BP126xxxAR